

BEAR BELL WITH MAGNETIC SILENCER



BB-01-XX

What does the SABRE® Bear Bell do?

- The Bear Bell is designed to help alert wildlife—especially bears—of your presence when hiking, camping, or exploring the outdoors. The ringing sound helps reduce the chance of surprise encounters. This model includes a magnetic silencer, allowing you to quickly and quietly silence the bell when not needed.

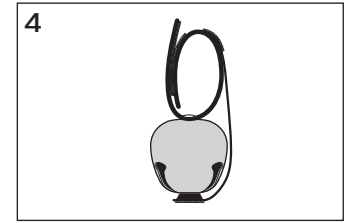
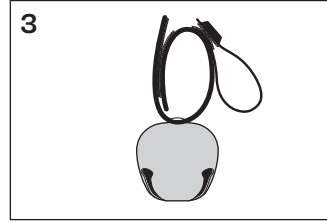
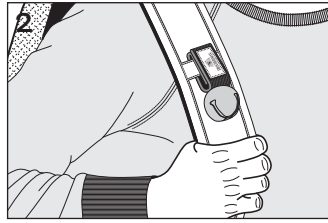
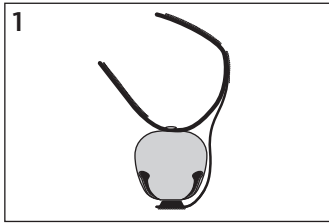

How to use the SABRE® Bear Bell:

Step 1: Attaching the Bell

1. Open the hook-and-loop strap (See Image 1).
2. Wrap the strap around a secure location (e.g., backpack loop, belt, etc) (See Image 2).
3. Press the hook-and-loop ends together firmly to hold the bell in place.

Step 2: Activating the Bear Bell (Silencer Not in Use)

1. Pull the bell gently away from the magnetic silencer so it can move freely.
2. The bell will jingle with your movement, alerting wildlife to your presence.
3. Secure the magnetic silencer to the hook-and-loop section at the top of the strap when not in use (See Image 3).

Step 3: Silencing the Bell (Silencer In Use)

1. Bring the bell into contact with the magnetic silencer (See Image 4).
2. The magnet will hold the metal bell in place, preventing it from ringing.
3. Use this mode when you're at camp, in quiet zones, or when noise is not desired.

Maintenance & Care:

- Wipe clean with a damp cloth after outdoor use.
- Dry thoroughly before storing to prevent rust.
- Keep away from strong magnets or electronic devices to avoid interference.
- Inspect the strap periodically for wear and replace if frayed.

⚠ WARNING

- This bell is **NOT A GUARANTEE** of safety against wildlife encounters - always practice proper outdoor safety and remain alert.
- **KEEP OUT OF THE REACH OF CHILDREN.**

LIMITATION OF LIABILITY: This limited warranty is your sole remedy and SECURITY EQUIPMENT CORPORATION shall not be liable for any damages, whether direct, indirect, incidental, special, consequential, exemplary or otherwise, including lost revenues and lost profits, arising out of any theory of recovery, including statutory, contract or tort. In no event will SECURITY EQUIPMENT CORPORATION'S entire liability exceed the purchase price of this product. Some states and provinces do not allow the exclusion or limitations of incidental or consequential damages so the above limitations or exclusions may not apply to you. This limited warranty gives you specific legal rights, and you may also have other rights which vary from state to state and province to province

CUSTOMER SERVICE CONTACT

SABRE® Security Equipment Corporation
815 Sun Park Drive
Fenton, MO 63026
customersupport@sabrered.com
Phone: 636-343-0200
Toll Free: 800-325-9568

MADE IN CHINA
11/10/2025