

# SPORT AND SAFETY HORN MANUAL

SSH-01



## What does the SABRE® Sport and Safety Horn do?

- The SABRE® SPORT & SAFETY HORN gives you the protection of a portable alarm system. The horn produces a powerful 130 dB blast. Up to 60 – ¼ second bursts. Up to 25 – ½ second bursts.

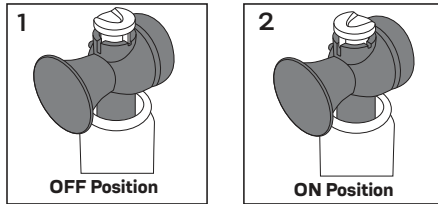

## How do I deploy my SABRE® Sport and Safety Horn?

- To lock the button when not in use, rotate the button counter-clockwise into the notch marked “off”. The button is now locked and will not accidentally deploy (see image 1).
- To unlock the horn, rotate the button clockwise, moving the indicator arrow towards the notch marked “on”. The Horn is ready to sound (see image 2).

## Instructions:

- For best results, deploy ¼ to ½ second bursts every ½ mile of terrain covered to alert animals or others of your presence.
- **ALWAYS HOLD CAN IN UPRIGHT POSITION. DO NOT SHAKE BEFORE OR DURING USE.**
- **USE ONLY SHORT BURSTS OR SPORT AND SAFETY HORN WILL NOT WORK.**
- Ensure the horn top is always hand tight to the canister for effective use.
- Removing the horn top from the canister is NOT recommended.

## ⚠ WARNING

**WARNING: KEEP OUT OF REACH OF CHILDREN. INTENTIONAL MISUSE BY DELIBERATELY CONCENTRATING AND / OR INHALING CONTENTS MAY BE FATAL. THIS SAFETY DEVICE CREATES A LOUD NOISE AND SHOULD NOT BE USED UNNECESSARILY OR NEAR EARS. DO NOT** store in direct sunlight, in a car or boat, or exposed to temperatures above 120°F (49°C), as overheating may cause can to burst. Liquid contents may cause frostbite upon contact with skin, therefore, do not tilt, shake or turn can upside down before or during use. **FIRST AID TREATMENT:** Contains trans-1,3,3,3-Tetrafluoroprop-1-ene. CAS# 29118-24-9. In all cases, contact physician. For medical emergencies in U.S. / Canada 1-800-498-7192. Do not pierce or burn even after use. Store in cool place. Use in well-ventilated place. Will not operate below 25°F (-4°C). **CAUTION!** Never attempt to remove back of horn. This could result in serious damage and violate warranty. **INSTRUCTIONS:** Avoid prolonged use, for best results deploy horn in short bursts. Allow canister to return to room temperature before deploying again, this may be accelerated by holding in hand to warm the canister. **Hold upright – do not tilt, shake or turn upside down before or during use.** For signal, depress top button. Prior to use, you **MUST** read & watch the warnings & instructions at [www.sabrered.com/safetytips](http://www.sabrered.com/safetytips). **NO** personal safety product, including this product, can guarantee your safety in an emergency. Failure to use properly could result in the inability to sound horn. Use counter measures if necessary.

**LIMITATION OF LIABILITY:** This limited warranty is your sole remedy and SECURITY EQUIPMENT CORPORATION shall not be liable for any damages, whether direct, indirect, incidental, special, consequential, exemplary or otherwise, including lost revenues and lost profits, arising out of any theory of recovery, including statutory, contract or tort. In no event will SECURITY EQUIPMENT CORPORATION'S entire liability exceed the purchase price of this product. Some states and provinces do not allow the exclusion or limitations of incidental or consequential damages so the above limitations or exclusions may not apply to you. This limited warranty gives you specific legal rights, and you may also have other rights which vary from state to state and province to province.

## CUSTOMER SERVICE CONTACT

SABRE® Security Equipment Corporation  
815 Sun Park Drive  
Fenton, MO 63026  
customersupport@sabrered.com  
Phone: 636-343-0200  
Toll Free: 800-325-9568



Made in United States with U.S  
and Imported Parts  
10/27/2025